

# MAKUHARI MESSE

Web-Site

(JAPANESE)<http://www.m-messe.co.jp/access/index.html>

(ENGLISH)<http://www.m-messe.co.jp/en/index.html>

Web-Site(access only)

(CHINESE)[http://www.m-messe.co.jp/access/access\\_china.html](http://www.m-messe.co.jp/access/access_china.html)

(KOREAN)[http://www.m-messe.co.jp/access/access\\_korea.html](http://www.m-messe.co.jp/access/access_korea.html)

# Access



# Access

## Narita Airport

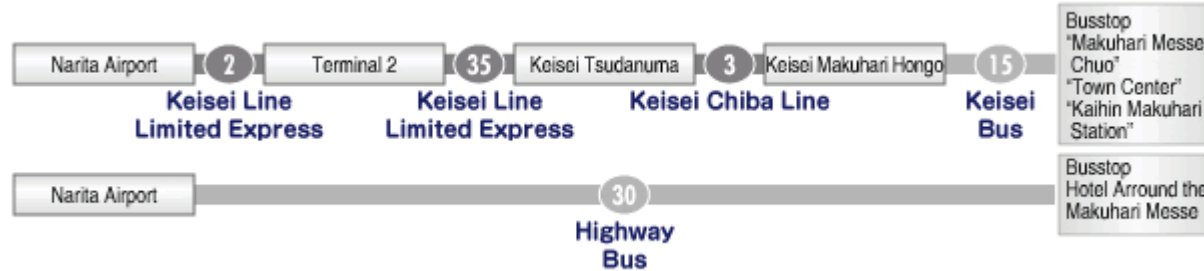

## Haneda Airport

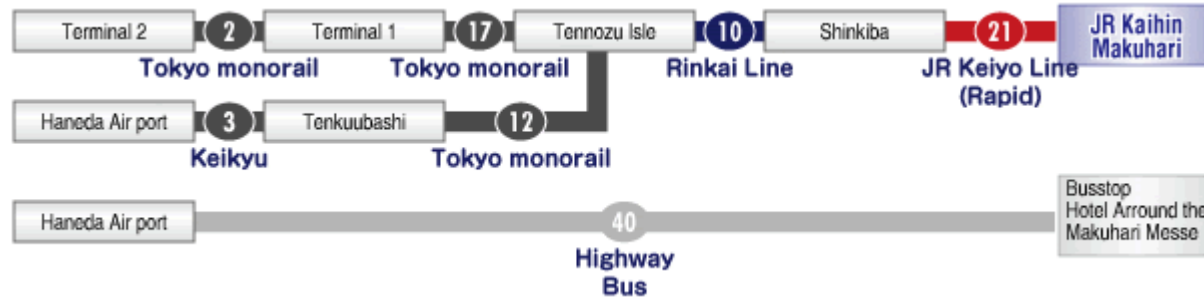

## Tokyo

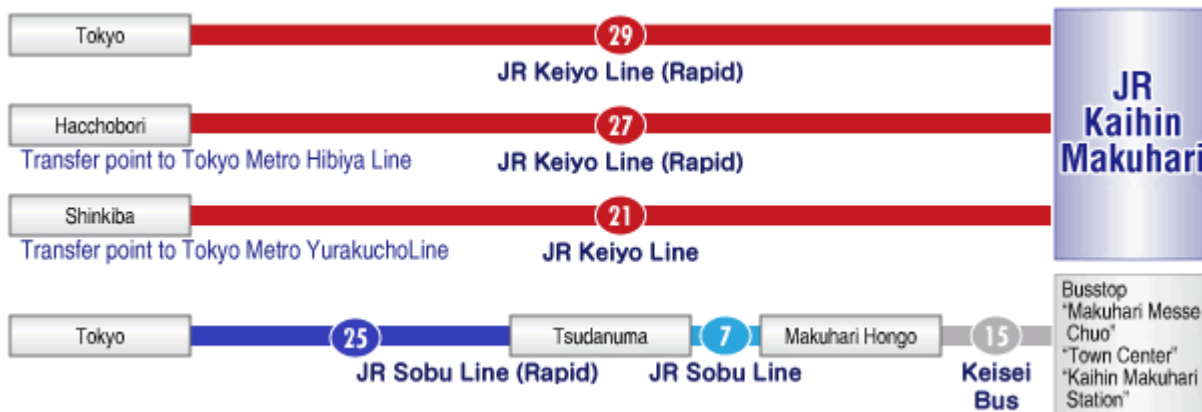

# Route from closest station (JR Kaihin-Makuhari station)

ITRS Public Conference

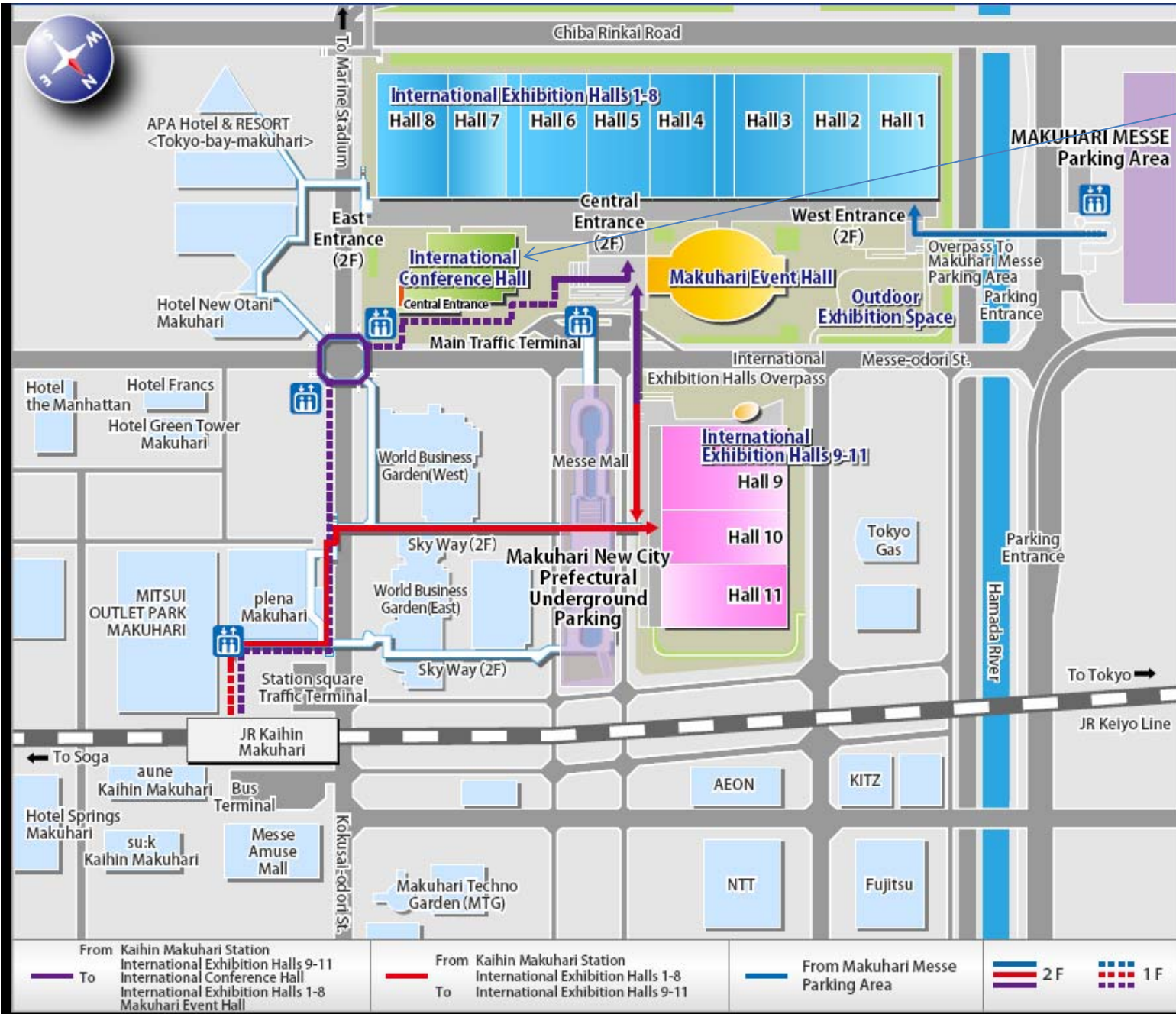

# MAKUHARI MESSE International Conference Hall

**This is world-class facility equipped with a large scale Convention Hall and International Conference Room as well as 16 small and medium-sized conference rooms.**

**Public  
Conference**

TO THE INTERNATIONAL EXHIBITION HALLS 1-8

**3<sup>rd</sup> floor**

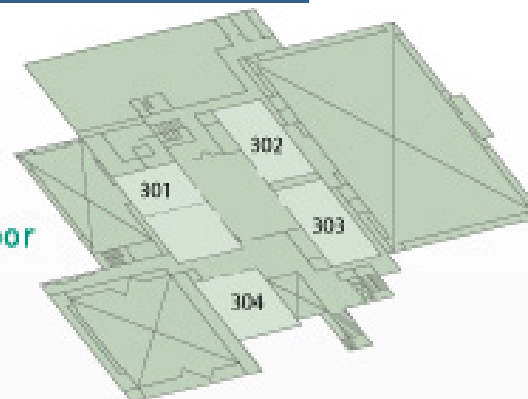

**2<sup>nd</sup> floor**

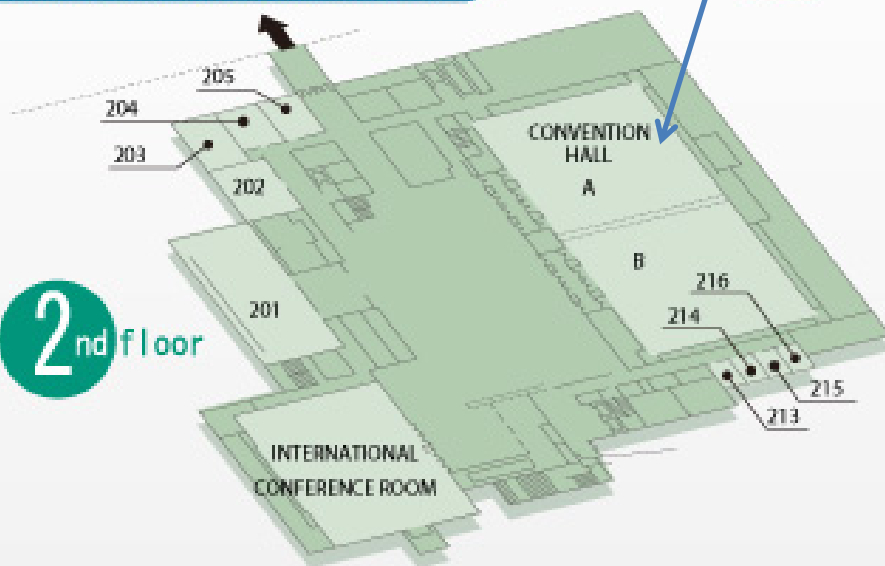

MAKUHARI MESSE, INC. OFFICE

VIP Reception Room 2

VIP Reception Room 1

CENTRAL  
ENTRANCE

**1<sup>st</sup> floor**

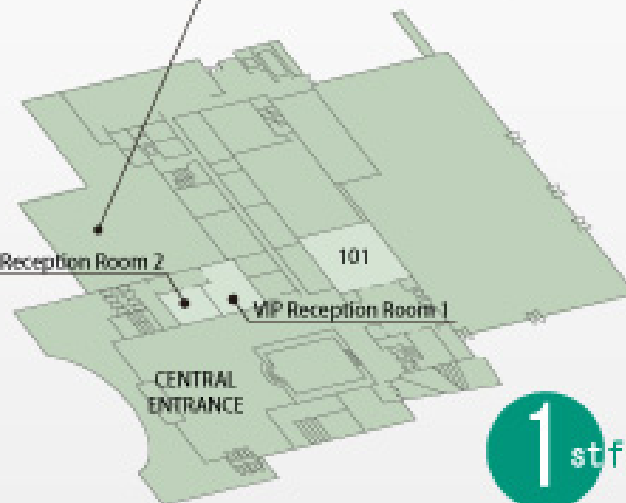

# Hotels in Makuhari Area ( Makuhari Messe ) & Chiba ⇔ Narita Airport

## Hotels in Makuhari Area (Makuhari Messe) & Chiba ⇔ Narita Airport

- One Way (Half fare for children) : ¥1, 100~1, 200
- Time Required (Makuhari Messe⇔Narita Airport) : Approx. 30~46min.

### ● INFORMATION

When you arrive at Narita Airport, having gone through the Customs area, just look for our friendly staff at our counters in the arrival lobby of Terminal 1 and 2. Busses from Narita Airport leave from the arrival lobby on the 1st floor.

Tickets can be purchased at our counters for Hotels in Makuhari Area (Makuhari Messe) & Chiba.

Our Airport Limousine keisei counters are located in the arrival lobbies (in front of the exit) of both Terminal 1 and 2.

Passengers planning to take the bus should obtain their tickets at the ticket counters before proceeding to the bus stops in New Tokyo International Airport

The limousine bus for New Tokyo International Airport (Narita) are being operated. You can buy the tickets at the bell captain desk.

Buses to Narita Airport set down in front of the departure lobbies of both passenger terminals.

Please allow plenty of time for travel to or from the airport as delays can occur due to traffic and weather conditions.

Reservation: As the limousine bus is a part of public transportation system, the seat capacity is limited and the reservation is not received.

## Bus departure timetable To Narita Airport

Chiba Chuo Sta	5:23	6:10	operates only on the weekday	operates only on the weekday	6:57	7:40	8:55	10:00	11:00	12:00	12:50	13:50	14:50	15:40	16:30	17:15
Keisei Hotel Miramare	→	6:15			7:02	7:45	9:00	10:05	11:05	12:05	12:55	13:55	14:55	15:45	16:35	17:20
Saiwaicho Daisan	5:27	6:20			7:07	7:52	9:07	10:12	11:12	12:12	13:02	14:02	15:02	15:52	16:42	17:27
Inage Kaigan Sta	5:38	6:30	7:00	7:15	7:17	8:05	9:20	10:25	11:25	12:25	13:15	14:15	15:15	16:05	16:55	17:40
Kemigawahama Sta	5:42	6:34	7:04	7:19	7:21	8:09	9:24	10:29	11:29	12:29	13:19	14:19	15:19	16:09	16:59	17:44
Makuhari Bay Town	5:45	6:37	7:07	7:22	7:24	8:12	9:27	10:32	11:32	12:32	13:22	14:22	15:22	16:12	17:02	17:47
Hotel Sprigs Makuhari	→	6:41	→	→	7:28	8:16	9:31	10:36	11:36	12:36	13:26	14:26	15:26	16:16	17:06	17:51
Kaihinmakuhari Sta	5:53	6:45	7:15	7:30	7:32	8:20	9:35	10:40	11:40	12:40	13:30	14:30	15:30	16:20	17:10	17:55
Hotel New Otani Makuhari	→	6:48	→	→	7:35	8:23	9:38	10:43	11:43	12:43	13:33	14:33	15:33	16:23	17:13	17:58
Hotel Francs	→	6:49	→	→	7:36	8:24	9:39	10:44	11:44	12:44	13:34	14:34	15:34	16:24	17:14	17:59
The Manhattan	→	6:50	→	→	7:37	8:25	9:40	10:45	11:45	12:45	13:35	14:35	15:35	16:25	17:15	18:00
Hotel Green Tower Makuhari	→	6:51	→	→	7:38	8:26	9:41	10:46	11:46	12:46	13:36	14:36	15:36	16:26	17:16	18:01
APA Hotel & Resort	5:56	6:55	→	→	7:42	8:30	9:45	10:50	11:50	12:50	13:40	14:40	15:40	16:30	17:20	18:05
Narita Aieport Terminal 2	6:26	7:35	7:48	8:03	8:22	9:10	10:25	11:30	12:30	13:30	14:20	15:20	16:20	17:10	18:00	18:45
Narita Aieport Terminal 1	6:31	7:40	7:53	8:08	8:27	9:15	10:30	11:35	12:35	13:35	14:25	15:25	16:25	17:15	18:05	18:50

One Way (Half fare for children) : \ 1, 1 0 0 (Makuhari Bay Town~APA Hotel & Resort to Narita Aieport)

## Bus departure timetable To Haneda Airport

Chiba Chuo Sta	4:40	5:00	5:30	6:00	6:40	7:20	8:00	8:40	9:10	9:40	10:10	10:40	11:10	11:40	12:00	12:30	13:00	13:40
Keisei Hotel Miramare	4:45	5:05	5:35	6:05	6:45	7:25	8:05	8:45	9:15	9:45	10:15	10:45	11:15	11:45	12:05	12:35	13:05	13:45
Saiwaicho Daisan	→	→	→	→	6:52	→	→	8:55	→	9:55	→	10:55	→	11:55	→	12:45	→	13:55
Inage Kaigan Sta	5:00	5:20	5:50	6:25	7:05	7:45	8:30	9:10	9:40	10:10	10:40	11:10	11:40	12:10	12:30	13:00	13:30	14:10
Kemigawahama Sta	5:04	5:24	5:54	6:29	7:09	7:49	8:34	9:14	9:44	10:14	10:44	11:14	11:44	12:14	12:34	13:04	13:34	14:14
Makuhari Bay Town	5:07	5:27	5:57	6:32	7:12	7:52	8:37	9:17	9:47	10:17	10:47	11:17	11:47	12:17	12:37	13:07	13:37	14:17
Hotel Sprigs Makuhari	→	→	→	→	7:16	→	→	9:21	→	10:21	→	11:21	→	12:21	→	13:11	→	14:21
Kaihinmakuhari Sta	5:15	5:35	6:05	6:40	7:20	8:00	8:45	9:25	9:55	10:25	10:55	11:25	11:55	12:25	12:45	13:15	13:45	14:25
Hotel New Otani Makuhari	→	→	→	→	7:23	→	→	9:28	→	10:28	→	11:28	→	12:28	→	13:18	→	14:28
Hotel Francs	→	→	→	→	7:24	→	→	9:29	→	10:29	→	11:29	→	12:29	→	13:19	→	14:29
The Manhattan	→	→	→	→	7:25	→	→	9:30	→	10:30	→	11:30	→	12:30	→	13:20	→	14:30
Hotel Green Tower Makuhari	→	→	→	→	7:26	→	→	9:31	→	10:31	→	11:31	→	12:31	→	13:21	→	14:31
APA Hotel & Resort	5:20	5:40	6:10	6:45	7:30	8:05	8:50	9:35	10:00	10:35	11:00	11:35	12:00	12:35	12:50	13:25	13:50	14:35
Haneda Aieport Terminal 2	5:57	6:17	6:47	7:32	8:17	8:52	9:32	10:17	10:42	11:17	11:42	12:17	12:42	13:17	13:32	14:07	14:32	15:17
Haneda Aieport Terminal 1	6:02	6:22	6:52	7:37	8:22	8:57	9:37	10:22	10:47	11:22	11:47	12:22	12:47	13:22	13:37	14:12	14:37	15:22

Chiba Chuo Sta	14:10	14:40	15:10	15:30	15:50	16:20	16:40	17:00	17:30	18:00	18:30	19:00	19:30	20:00	20:30	21:10	21:45
Keisei Hotel Miramare	14:15	14:45	15:15	15:35	15:55	16:25	16:45	17:05	17:35	18:05	18:35	19:05	19:35	20:05	20:35	21:15	21:50
Saiwaicho Daisan	→	→	15:25	→	→	16:35	→	→	17:45	→	→	→	→	→	→	→	→
Inage Kaigan Sta	14:40	15:10	15:40	16:00	16:20	16:50	17:10	17:30	18:00	18:30	19:00	19:20	19:50	20:20	20:50	21:30	22:05
Kemigawahama Sta	14:44	15:14	15:44	16:04	16:24	16:54	17:14	17:34	18:04	18:34	19:04	19:24	19:54	20:24	20:54	21:34	22:09
Makuhari Bay Town	14:47	15:17	15:47	16:07	16:27	16:57	17:17	17:37	18:07	18:37	→	19:27	→	→	→	→	→
Hotel Sprigs Makuhari	→	→	15:51	→	→	17:01	→	→	18:11	→	→	→	→	→	→	→	→
Kaihinmakuhari Sta	14:55	15:25	15:55	16:15	16:35	17:05	17:25	17:45	18:15	18:45	→	19:35	→	→	→	→	→
Hotel New Otani Makuhari	→	→	15:58	→	→	17:08	→	→	18:18	→	→	→	→	→	→	→	→
Hotel Francs	→	→	15:59	→	→	17:09	→	→	18:19	→	→	→	→	→	→	→	→
The Manhattan	→	→	16:00	→	→	17:10	→	→	18:20	→	→	→	→	→	→	→	→
Hotel Green Tower Makuhari	→	→	16:01	→	→	17:11	→	→	18:21	→	→	→	→	→	→	→	→
APA Hotel & Resort	15:00	15:30	16:05	16:20	16:40	17:15	17:30	17:50	18:25	18:50	→	19:40	→	→	→	→	→
Haneda Aieport Terminal 2	15:42	16:12	16:47	17:02	17:22	17:57	18:12	18:32	19:07	19:32	19:47	20:17	20:32	20:57	21:27	22:07	22:42
Haneda Aieport Terminal 1	15:47	16:17	16:52	17:07	17:27	18:02	18:17	18:37	19:12	19:37	19:52	20:22	20:37	21:02	21:32	22:12	22:47